



ASSEMBLY INSTRUCTIONS

PART-NO: 315002



V-MAX mini

JUST PUSH IT

Requirements for mounting the bracket for the AAT V-MAX mini:

1. The bracket for the V-MAX mini can be attached to a wheelchair frame diameter of Ø18 - 30.5mm.
2. The bracket for the V-MAX mini is suitable for wheelchairs with seat widths from 36cm to 48 cm.
3. Do not assemble the bracket to wheelchairs which are damaged.
4. The assembly may only be executed by trained persons.
5. The use of drum brakes is strictly recommended.
6. The device may only be used in conjunction with two original tilt supports from the wheelchair manufacturer.
7. The permissible total weight must not be exceeded.
8. No assembly may be performed on angular frame tubes (rectangular or quadratic).
9. Make sure that the wheelchair is CE marked.

Procedure:

1. Determine the position in which the bracket is to be assembled.
2. Remove the wheelchair wheels.
3. Assemble the V-MAX mini mount as described below.
4. Mount the previously disassembled wheels.
5. Check that the drive has enough space to swing freely upwards.
6. Adjust the angle of the device as described below.
7. Tighten the screws of the bracket. Make sure that the wheelchair frame is not damaged by overtightening the screws.
8. Mount the battery holder and the thumb gas as described below.
9. Perform a test drive.
10. Make sure that the device works properly and the mobility is not restricted by the cross brace of the wheelchair.

Assembly example with drum brake

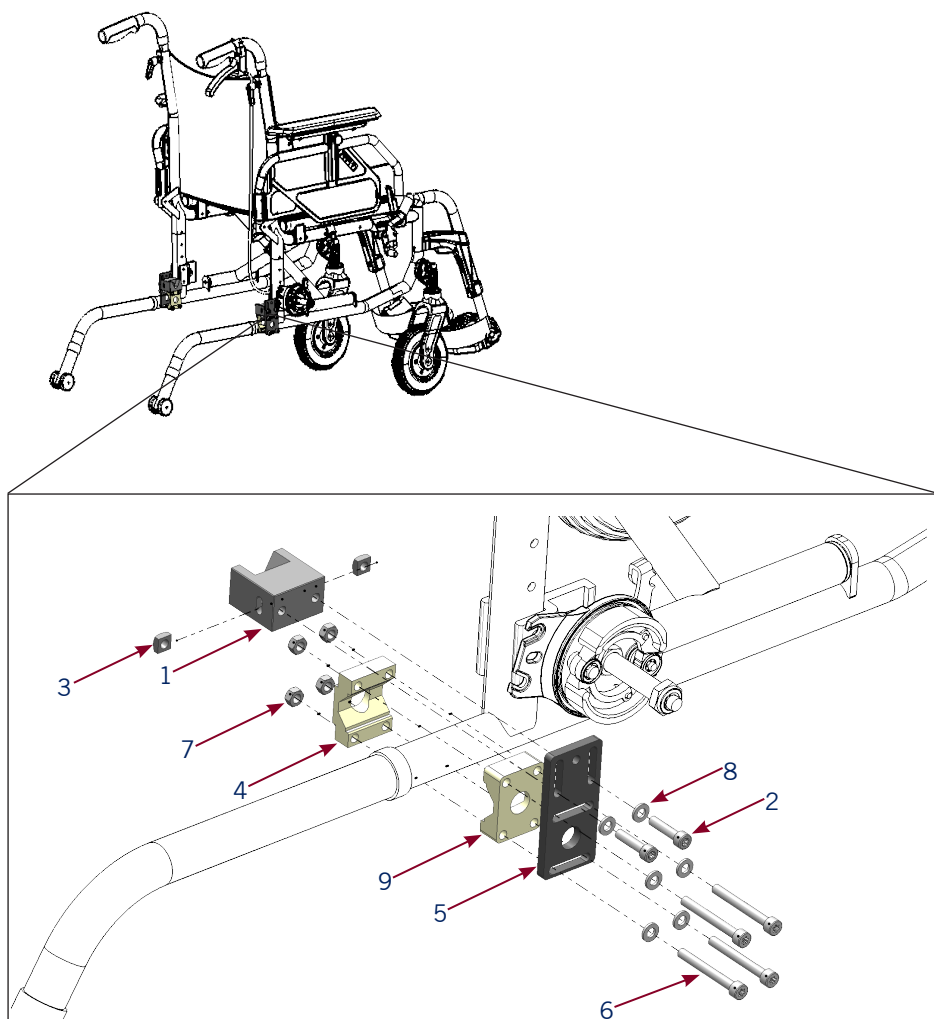

Bill of material

Pos	Teil	Bezeichnung 1	Bezeichnung 2	Anzl
1	042106	Hanger for release shafts	V-MAX mini	2
2	042633	Zylinderschraube mit Torx	ISO 14579-M6x25-8.8	4
3	031871	square nut	DIN 557-M6-5	4
4	042332	bracket clamp wide for	assembly of P1204	2
5	042672	Adapter plate	v-max mini	2
6	001222	Cylinder screw with hexagon	socket DIN 912-M6x50-8.8	8
7	000301	Hexagon nut with clamping part	DIN 985-M6-8	8
8	000245	Disc	DIN 125-A6.4 (M6)	12

Assemble the bolts (pos.6) with the nuts (pos.7).
These are tightened with a torque of 4Nm.

The bracket must be assembled at right angles to the floor.

Mounting example without drum brake

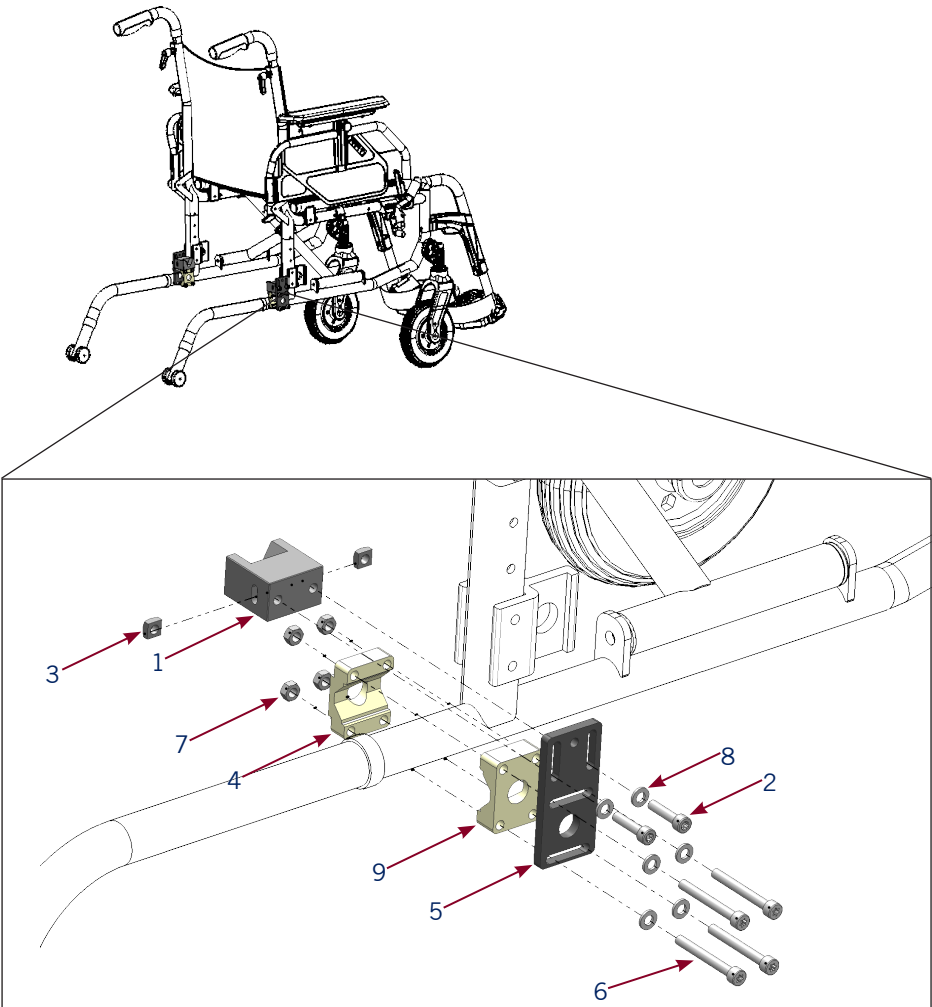

Bill of material

Pos	Teil	Bezeichnung 1	Bezeichnung 2	Anzl
1	042106	Hanger for release shafts	V-MAX mini	2
2	042633	Zylinderschraube mit Torx	ISO 14579-M6x25-8.8	4
3	031871	square nut	DIN 557-M6-5	4
4	042332	bracket clamp wide for	assembly of P1204	2
5	042672	Adapter plate	v-max mini	2
6	001222	Cylinder screw with hexagon	socket DIN 912-M6x50-8.8	8
7	000301	Hexagon nut with clamping part	DIN 985-M6-8	8
8	000245	Disc	DIN 125-A6.4 (M6)	12

Assemble the bolts (pos.6) with the nuts (pos.7).
These are tightened with a torque of 4Nm.

The bracket must be assembled at right angles to the floor.

Assembly range

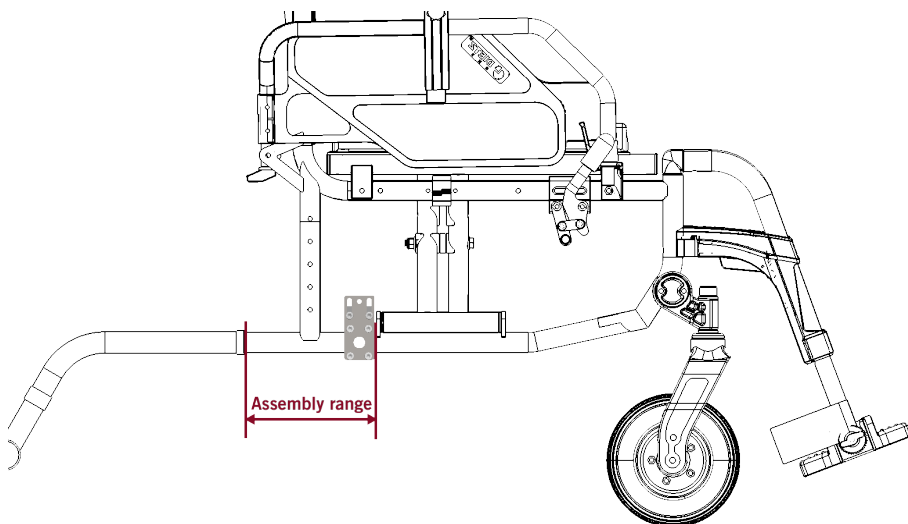

Sample illustration

Note the assembly range illustrated above.

The bracket must be attached in a position where the unit can swing freely and does not get blocked by the cross brace.

However the position should be as far forward as possible so that the accompanying person's freedom of movement is restricted as little as possible.

Adjustment of the drive

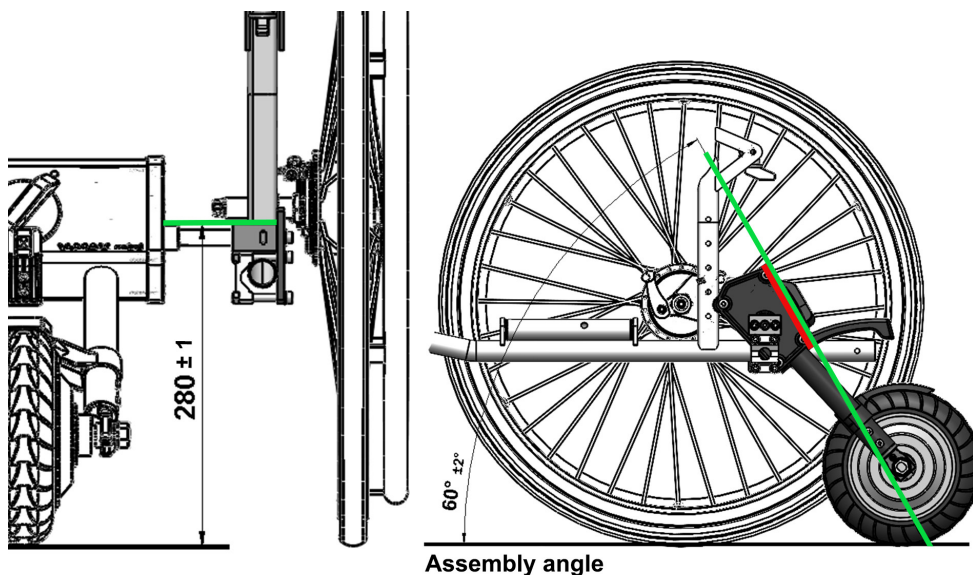

Sample illustration

To ensure optimum traction of the drive unit, set the upper edge of the hanger for release shafts (Pos.1) to a dimension of 280 ± 1 mm to the floor.

This results in an angle of the drive unit (**measured at the housing**) of $60^\circ \pm 2^\circ$ to the floor.

After setting the angle, the screws (pos. 2) must be tightened to fix the position. Please observe the applicable tightening torques.

Battery plate and thumb throttle without drum brake

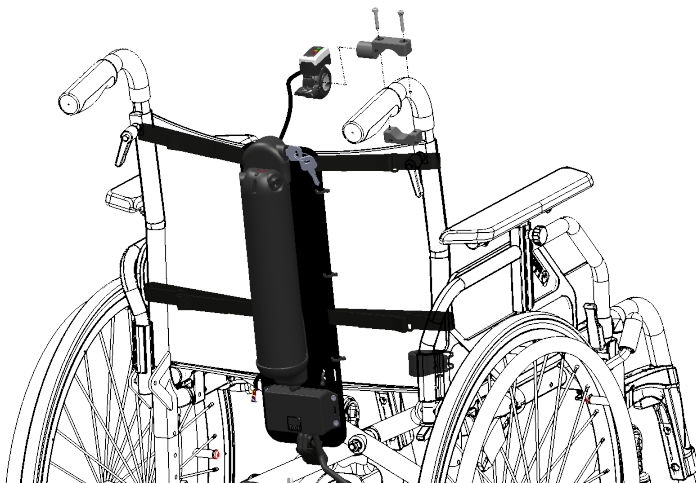

Sample illustration

**Please make sure that the battery plate is attached to the wheelchair in a way that no function of the wheelchair is impaired.
Make sure that no cables can be pinched or damaged.**

**Attach the thumb throttle bracket as shown in the illustration.
To do this, use the supplied assembling set and the corresponding screws.**

Battery plate and thumb throttle with drum brake

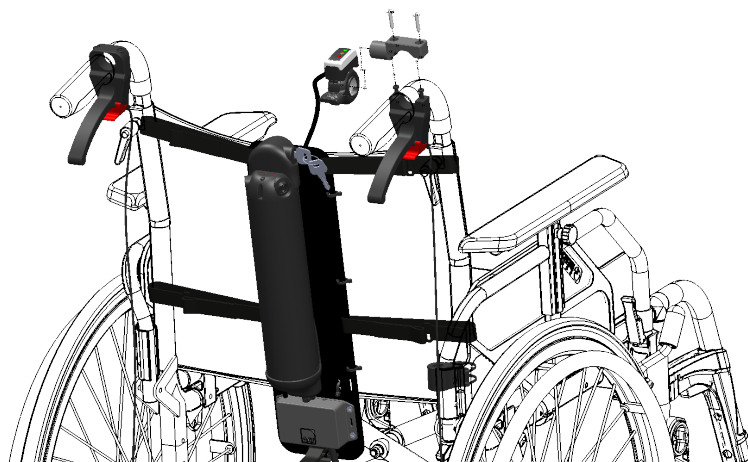

Sample illustration

Please make sure that the battery plate is attached to the wheelchair in a way that no function of the wheelchair is impaired. Make sure that no cables can be pinched or damaged.

Remove the upper clamp of the original brake lever and replace it with the bracket supplied. Attach the thumb throttle bracket to the brake lever using the supplied screws.

Unless otherwise specified, bolted joints of strength class 8.8 or higher shall be tightened as follows.	
Thread size	Tightening torque in Nm
M3	1,1
M4	3
M5	5
M6	10
M8	25



Attention! Installation may only be carried out by specialists authorized by the manufacturer.



Important note for tilt supports!

Before operating the device, check the original tilt supports of the wheelchair manufacturer to ensure safety.



Secure screw connections!

All screw connections must be provided with screw lock.



Pay attention to the tightening torques!

The tightening torques in the adjacent table must be strictly observed!

Assembly instructions

The brackets must be assembled parallel to the wheelchair.

The brackets must be installed perpendicular to the floor.

Notes

13

Notes

Notes

15



Your Contact:

AAT-Bracket assembly department · Sigmaringer-Straße 100 · 72458 Albstadt
Tel.: +49.(0) 74 31.12 95-537 · anbau@aat-online.de

Date: 19.12.2024 Version: 2 Picked by:



www.aat-online.de